

Highway 169 Land

150th Street West & Highway 169, Louisville Township, Minnesota

54 Acres For Sale



Property Highlights:

- Offering price of \$1,200,000.
- Flexible I-1 Rural Industrial zoning.
- 1/2 mile of highway exposure.
- 30,000+ vehicles per day along 169 (2010). Billboard location.
- Potential Contract for Deed.
- Contact these listing agents for additional information:

Stephen Dombrovski
DD: 651.209.9612
E: Steve@suntide.com

Jodi Walfoort
DD: 651.209.9628
E: Jodi@suntide.com



Highway 169 Land

150th Street West and Highway 169, Louisville Township, Minnesota 55379

2010 Demographics	3 Mile	5 Mile	7 Mile
Total Population	4,482	29,960	75,375
Households	1,492	10,553	26,983
Avg. Income	\$96,907	\$86,247	\$94,305

Location Map

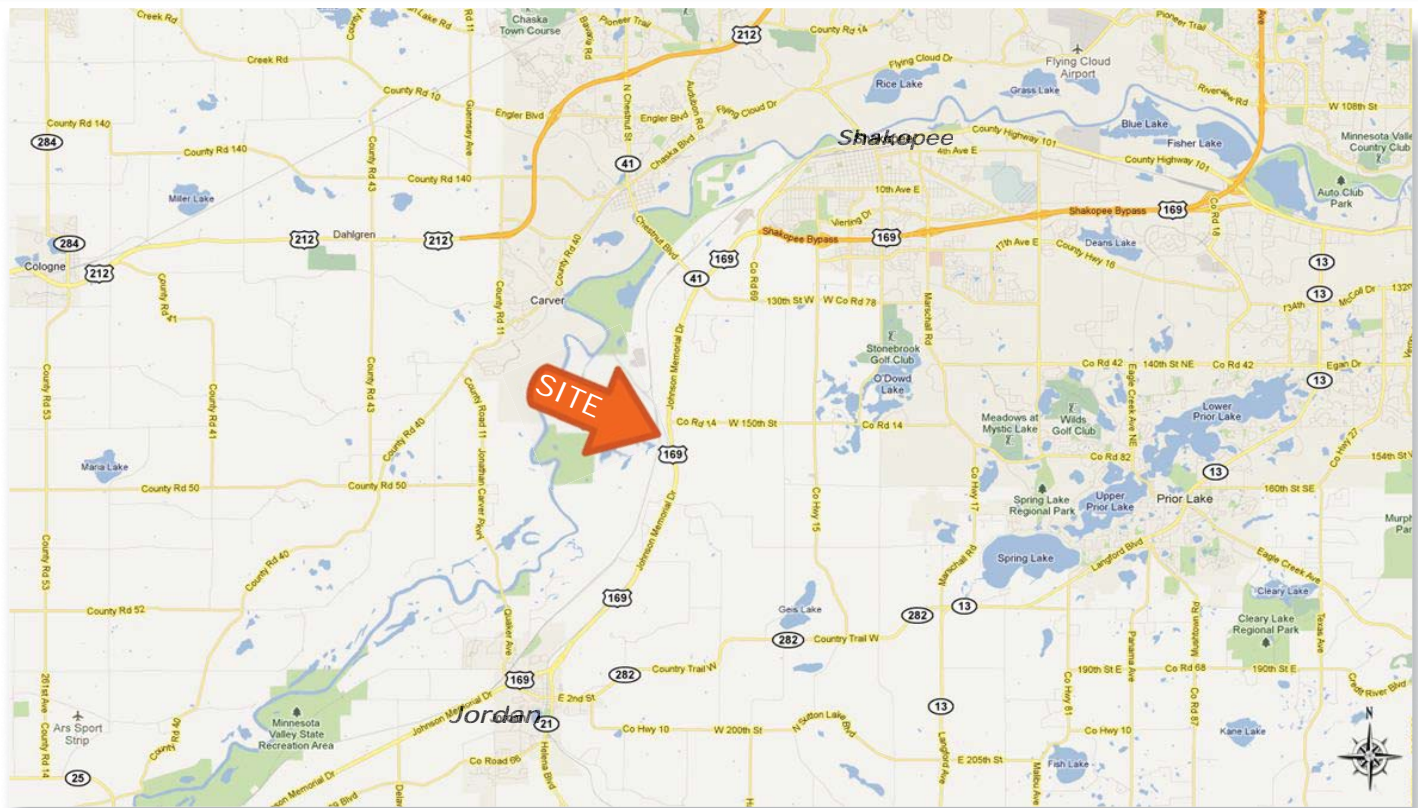

Additional Details

This 54 acre property is located in Louisville Township, between Shakopee and Jordan, Minnesota within Scott County. 2011 taxes, including any spec's, are approximately \$4,834.

The site features a notably large cache of sandstone and frac sand deposits.

2010 traffic counts estimate more than 30,000 vehicles per day along this section of Highway 169.

Rail served: potential for a rail spur on the property.



DISCLAIMER: The information contained herein was obtained from sources believed to be reliable, but Suntide Commercial Realty Inc has not verified nor has any knowledge regarding the accuracy or completeness of information and makes no representation or warranty concerning the same. Therefore, Suntide Commercial Realty disclaims all liabilities in connection with any inaccuracies or incompleteness.

